

kanopy

Streaming Movies

Getting Started

- Visit dglibrary.kanopy.com
- OR-
- Visit your device's app store ([Apple App Store](#), [Google Play Store](#), etc.) and download the **Kanopy** app.
- Select **Add A Library Card**, and follow the on-screen instructions by providing your library card number, PIN, email address, and creating a password.

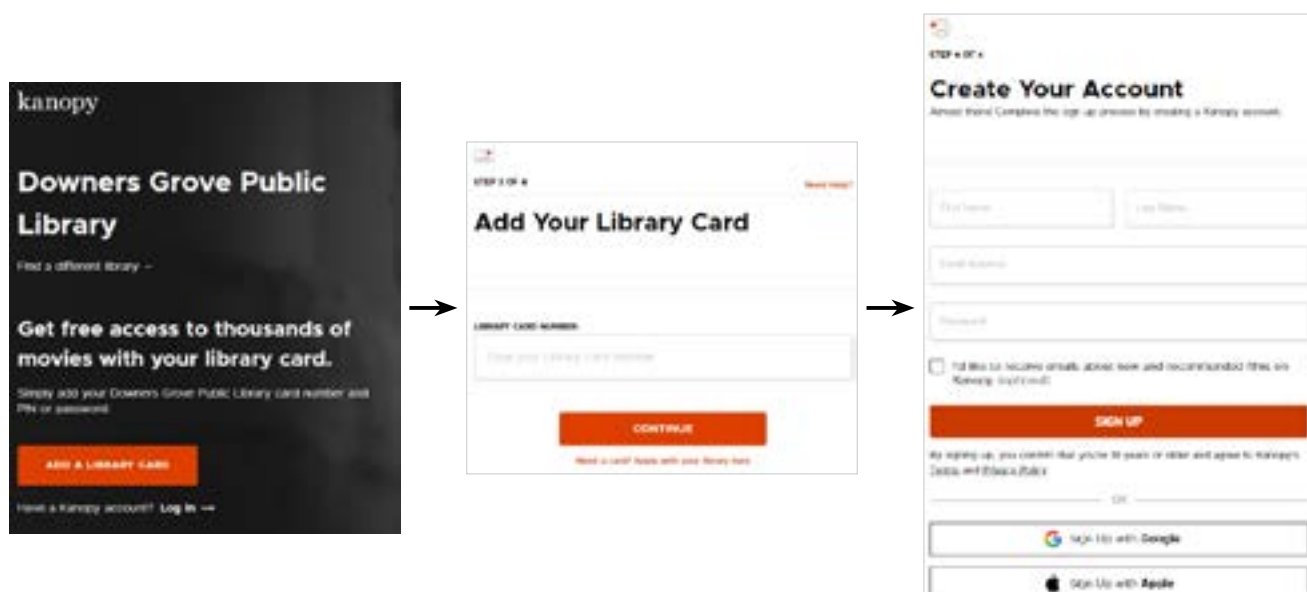

Ticket System

- Each month, you will receive 12 tickets to use towards movies or shows. Every title will be labeled with a ticket cost and lending period window. Some common costs/lender periods are:
 - Most films cost 2 tickets and last 72 hours
 - Some major movie studios like MGM cost 4 tickets and last 48 hours
 - Great Courses and TV shows (by the season) will vary depending on the total duration.
 - Kids content does not use tickets: you can access an unlimited number of Kanopy Kids titles each month.
- You will see how many credits you currently have remaining at the top of the page.
- You can find titles based on how many tickets are required to watch a title using the **Tickets** filter in the **Filters** menu.



Finding Movies and Series

- You can search for movies and series by selecting the search bar at the top of the screen.
- OR-
- You can browse by subject and category by selecting the browse tab at the top of the screen.



- To watch a title, select the **Play Button**. Tickets will automatically be deducted from your account and begin the lending window countdown.
- See how much time you have remaining on any given rental by viewing either the titles thumbnail on your continue watching screen or the title's information page.

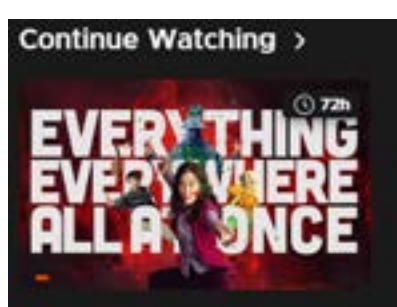

Things to Know

- Unused tickets do not roll over.
- You will log in with your email and password, not your library card number, after the initial setup.
- Tickets will refresh at midnight on the 1st of each month.
- You can watch rented items as many times as you like during your checkout period.

Need help? Call 630-960-1200 or email ATS@dglibrary.org.

Checking out items from Kanopy

- Each patron gets 12 tickets per month. This is reset on the first of every month.
- The library has a limit on total library-wide checkouts per month. This is reset on the first of every month.

If either of these limits are met, patrons must wait until the limit has been reset.

While waiting, the library encourages patrons to check out Hoopla, Libby by Overdrive, and cloudLibrary.

Patron's Monthly Limit is Met:

The Library's Monthly Limit is Met:

*Due to budgetary restraints, this limit may change without notice.